

Series 540, Model 2-3 with Packing

Subject to change without notice
F.O.B. Windsor, Ontario

Supercedes all previous parts lists

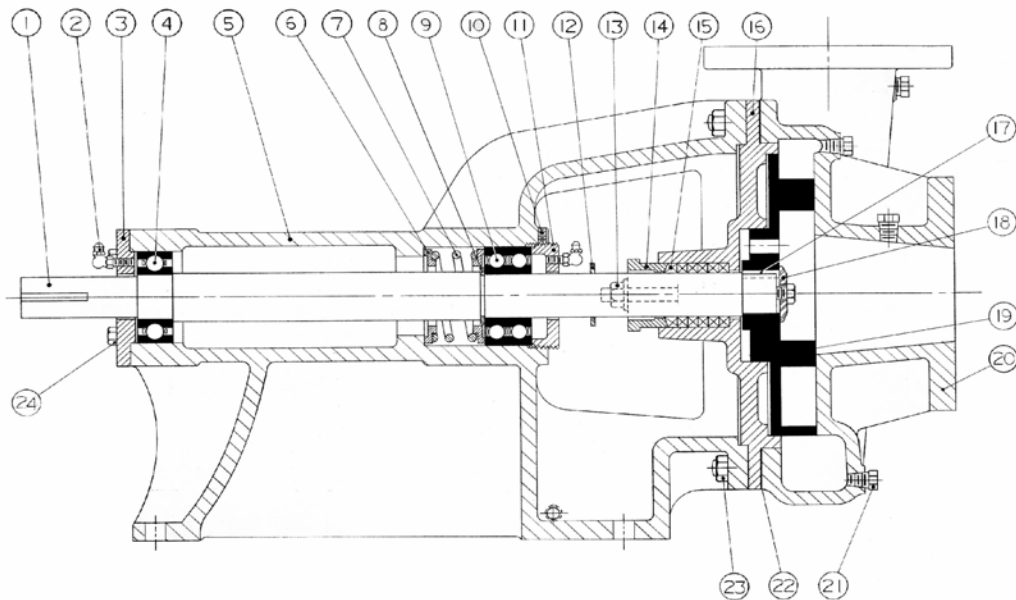

| ITEM | DESCRIPTION | MATERIAL | PART NUMBER | QTY | PRICE |
|------|-------------------------|------------------------------------|------------------|-----|-------|
| 1 | Shaft | Steel | 480-12-450-640 | 1 | |
| | | 304 Stainless Steel | 480-13-450-550 | 1 | |
| 2 | Grease Fitting | 1/4-28 90 Deg Grease Fitting | 325-10-025-605 | 2 | |
| 3 | Bearing Cap | Iron | 180-12-300-310 | 1 | |
| 4 | Outer Ball Bearing | Steel - 3207 C3 | 150-00-250-605 | 1 | |
| 5 | Bracket | Iron | 165-12-300-310 | 1 | |
| 6 | Spring Retainer | Aluminum | 145-12-100-010 | 2 | |
| 7 | Spring | Spring Steel - M1631A | 495-10-100-605 | 1 | |
| 8 | Retaining ring | Spring Steel - 1460-118 | 430-10-050-605 | 1 | |
| 9 | Inner Ball Bearing | Steel - 3307 C3 | 150-10-150-605 | 1 | |
| 10 | Set Screw | 5/16-18X5/16 Cup Point Set Screw | 355-00-291-660 | 1 | |
| 11 | Adjusting Nut | Iron | 100-12-050-310 | 1 | |
| 12 | Shaft Flinger | Rubber | 240-10-425-450 | 1 | |
| 13 | Packing Gland Fasteners | 7/16-14X3 1/2 T11/16 N21/2 Stud | 335-00-436-620 | 2 | |
| | | 7/16-14 Heavy Hex Nut | 355-00-588-660 | 2 | |
| | | 7/16" Lockwasher | 355-00-535-660 | 2 | |
| 14 | Packing Gland | Iron | 370-12-450-310 | 1 | |
| 15 | Packing Ring Set | Standard Packing - C1065 | 365-10-240-780 | 1 | |
| 16 | Back Plate | Iron | 110-12-200-310 | 1 | |
| 17 | Square Key | 3/8X3/8X7/8 Keystock | 310-10-075-530 | 1 | |
| 18 | Impeller Fasteners | Washer - Stainless Steel - C2590-4 | 515-10-050-530 | 1 | |
| | | 1/2-13X1 1/4 Hex Cap Screw | 355-00-123-530 | 1 | |
| | | 1/2" Lockwasher | 355-00-538-530 | 1 | |
| 19 | Impeller | Iron | 305-12-560-310 | 1 | |
| 20 | Casing | Iron | 190-12-225-310-S | 1 | |
| 21 | Pipe Plug | 1/4-18 Hex Head Plug | 390-00-125-605 | 4 | |
| 22 | Casing Gasket | Standard | 245-10-070-240 | 3 | |
| 23 | Casing Fasteners | 7/16-14X2 1/4 T5/8 N7/8 Stud | 355-00-433-620 | 12 | |
| | | 7/16-14 Heavy Hex Nut | 355-00-588-660 | 12 | |
| 24 | Bearing Cap Bolts | 5/16-18X3/4 Hex Cap Screw-Grade 5 | 355-00-035-670 | 4 | |

*** Specify the impeller diameter or serial number with every order.
Casing may not be exactly as shown.